

# EAST 66TH STREET TLCI

CLEVELAND, OHIO

JUNE 30, 2020  
SCHEMATIC DESIGN

## PROJECT TEAM

**OWNER**  
**CITY OF CLEVELAND**  
601 LAKESIDE AVENUE  
CLEVELAND, OH 44114  
PHONE: (216) 664-2000

**METROPOLITAN PLANNING ORGANIZATION**  
**NORTHEAST OHIO AREAWIDE**  
**COORDINATING AGENCY**  
1299 SUPERIOR AVENUE  
CLEVELAND, OH 44114  
PHONE: (216) 241-2414

**COMMUNITY ENGAGEMENT**  
**TWELVE LITERARY ARTS**  
1484 EAST 105TH STREET  
CLEVELAND, OHIO 44106  
PHONE: (216) 350-6333

**NEIGHBORHOOD LEADERSHIP**  
**MIDTOWN CLEVELAND**  
5000 EUCLID AVENUE  
CLEVELAND, OH 44103  
PHONE: (216) 391-5080

**ARCHITECT / PLANNING**  
**CITY ARCHITECTURE, INC**  
3200 EUCLID AVENUE  
CLEVELAND, OH 44115  
PHONE: (216) 881-2444

**COMMUNITY ENGAGEMENT**  
**LATTIMORE PRODUCTIONS**  
ALEXANDRIA.LATTIMORE@GMAIL.COM

**NEIGHBORHOOD LEADERSHIP**  
**FAMICOS FOUNDATION**  
1325 ANSEL ROAD  
CLEVELAND, OH 44106  
PHONE: (216) 791-6476

**CIVIL ENGINEERING**  
**OSBORN ENGINEERING**  
1100 SUPERIOR AVENUE, SUITE 300  
CLEVELAND, OH 44114  
PHONE: (216) 861-2020

**LANDSCAPE DESIGN**  
**MERRITT CHASE**  
166 46TH STREET  
PITTSBURGH, PA 15201  
PHONE: (954) 881-4204

## INDEX OF DRAWINGS

A0.0	TITLE SHEET	2020-06-16
A0.1	OVERALL PLAN & BASIS OF DESIGN SUMMARY	2020-06-16
A0.2	TYPICAL STREET SECTION	2020-06-16

## ARCHITECTURAL

A1.1	EAST 66TH AT EUCLID AVE	2020-06-16
A1.2	EAST 66TH BETWEEN EUCLID & CHESTER	2020-06-16
A1.3	EAST 66TH AT CHESTER AVE	2020-06-16
A1.3A	EAST 66TH AT CHESTER AVE - ENLARGED PLAN	2020-06-16
A1.4	EAST 66TH BETWEEN CHESTER & HOUGH	2020-06-16
A1.5	EAST 66TH AT HOUGH AVE	2020-06-16
A1.6	EAST 66TH BETWEEN HOUGH & LEXINGTON	2020-06-16
A1.7	EAST 66TH AT LEXINGTON AVE	2020-06-16
A1.7A	EAST 66TH AT LEXINGTON AVE - ENLARGED PLAN	2020-06-16
A1.8	EAST 66TH NORTH OF LEXINGTON	2020-06-16
A1.9	EAST 66TH BETWEEN LEXINGTON & WADE PARK	2020-06-16
A1.10	EAST 66TH SOUTH OF WADE PARK	2020-06-16
A1.11	EAST 66TH AT WADE PARK AVE	2020-06-16
A1.12	EAST 66TH NORTH OF WADE PARK AVE	2020-06-16
A1.13	EAST 66TH SOUTH OF SUPERIOR AVE	2020-06-16
A1.14	EAST 66TH AT SUPERIOR AVE	2020-06-16

## ARCHITECTURAL ABBREVIATIONS

ADJ.	ADJACENT	F.D.	FLOOR DRAIN	PERF.	PERFORATED
A.F.F.	ABOVE FINISH FLOOR	F.F.	FINISH FLOOR	P.LAM.	PLASTIC LAMINATE
ALLOW.	ALLOWANCE	FIN.	FINISH	PLUMB.	PLUMBING
ALT.	ALTERNATE	FLR.	FLOOR	PLYWD.	PLYWOOD
ALUM.	ALUMINUM	F.R.T.	FIRE RETARDANT	PR.	PAIR
APPROX.	APPROXIMATELY	FT.	FEET, FOOT	PSF	POUND/SQUARE FOOT
ARCH.	ARCHITECTURAL	FTG.	FOOTING	P.T.	PRESSURE TREATED
B&B	BALLED & BURLAPPED	GALV.	GALVANIZED	PTD.	PAINTED
BD.	BOARD	G.C.	GENERAL CONTRACTOR	R	RISER
BLDG.	BUILDING	G.L.	GLASS	RAD.	RADIUS
BLK.	BLOCK	GLZ.	GLAZING	R.D.	ROOF DRAIN
BLKG.	BLOCKING	GSF	GROSS SQUARE FEET	REF.	REFER TO
BM	BEAM	GWB	GYPSON WALL BOARD	REFL.	REFLECTED
BRG.	BEARING	GYP.	GYPSON	REINF.	REINFORCED
BTW.	BETWEEN	H.A.	HEAVY DUTY	REQ'D.	REQUIRED
B/O	BOTTOM OF	HT.	HEIGHT	R.C.P.	REFLECTED CEILING PLAN
C.B.	CATCH BASIN	H.M.	HOLLOW METAL	R.L.	ROOF LEADER
C.J.	CONTROL JOINT	HORIZ.	HORIZONTAL	RM.	ROOM
C.L.	CENTER LINE	HP	HIGH POINT	R.O.	ROUGH OPENING
CLS.	CEILING	INFO.	INFORMATION	RTU	ROOF TOP UNIT
CLOS.	CLOSET	INSUL.	INSULATION, INSULATED	SOW	SOLID CORE WOOD
CMU	CONCRETE MASONRY UNIT	INT.	INTERIOR	SECT.	SECTION
COL.	COLUMN	JAN.	JANITOR'S	S.F.	SQUARE FEET
COL'S.	COLUMNS	JT.	JOINT	SHR.	SHEET
COMP.	COMPRESSIBLE	KIT.	KITCHEN	SIM.	SIMILAR
CONC.	CONCRETE	L.	LENGTH	SPECS.	SPECIFICATIONS
CONT.	CONTINUOUS	LAM.	LAMINATE	S.S.	STAINLESS STEEL
CONSTR.	CONSTRUCTION	LAV.	LAVATORY	S.S.M.	SOLID SURFACE MATERIAL
COORD.	COORDINATE	LWT.	LIGHTWEIGHT	STD.	STANDARD
CTR.	CENTER	MFR.	MANUFACTURER	STL.	STEEL
DET.	DETAIL(S)	MAS.	MASONRY	STND.	STAINED
DIA.	DIAMETER	MATL.	MATERIAL	STOR.	STORAGE
DIAG.	DIAGRAM	MAX.	MAXIMUM	STRUCT.	STRUCTURAL
DIMS.	DIMENSIONS	MDO	MEDIUM DENSITY OVERLAY	SUSP.	SUSPENDED
DN.	DOWN	MDF	MEDIUM DENSITY FIBERBOARD	THK.	THICK
DS	DOWNSPOUT	MECH.	MECHANICAL	TLT.	TOILET
DWG(S)	DRAWING(S)	MTL.	METAL	T.O.	TOP OF
EA	EACH	MIN.	MINIMUM	T.	TREAD
EIFS	EXTERIOR INSULATION FINISH SYSTEM	MMU.	MANUFACTURED MASONRY UNIT	TYP.	TYPICAL
E.J.	EXPANSION JOINT	M.O.	MASONRY OPENING	U.L.	UNDERWRITERS LABORATORY
ELEV(S)	ELEVATION(S)	M.P.T.	MIDPOINT	U.N.O.	UNLESS NOTED OTHERWISE
ELEC.	ELECTRICAL	MTD.	MOUNTED	V.B.	VAPOR BARRIER
ETC.	ET CETERA	N.I.C.	NOT IN CONTRACT	VERT.	VERTICAL
E.T.R.	EXISTING TO REMAIN	NOM.	NOMINAL	V.I.F.	VERIFY IN FIELD
EQ.	EQUAL	NSF	NET SQUARE FOOTAGE	W.	WIDTH
EWIC.	ELECTRIC WATER COOLER	NTS	NOT TO SCALE	W/I	WITH
EXST.	EXISTING	OI	OVER	W/O	WITHOUT
EXP.	EXPANSION	O.C.	ON CENTER	WD	WOOD
EXT.	EXTERIOR	O.D.	OUTSIDE DIAMETER	W.P.	WORK POINT
FE.	FIRE EXTINGUISHER	O.H.	OVERHEAD	/FT	PER FOOT
FEC.	FIRE EXTINGUISHER CABINET	OSB	ORIENTED STRAND BOARD	@	AT
		PART.	PARTITION	±	PLUS OR MINUS
				°	DEGREE
				Ø	DIAMETER

## LOCATION PLAN

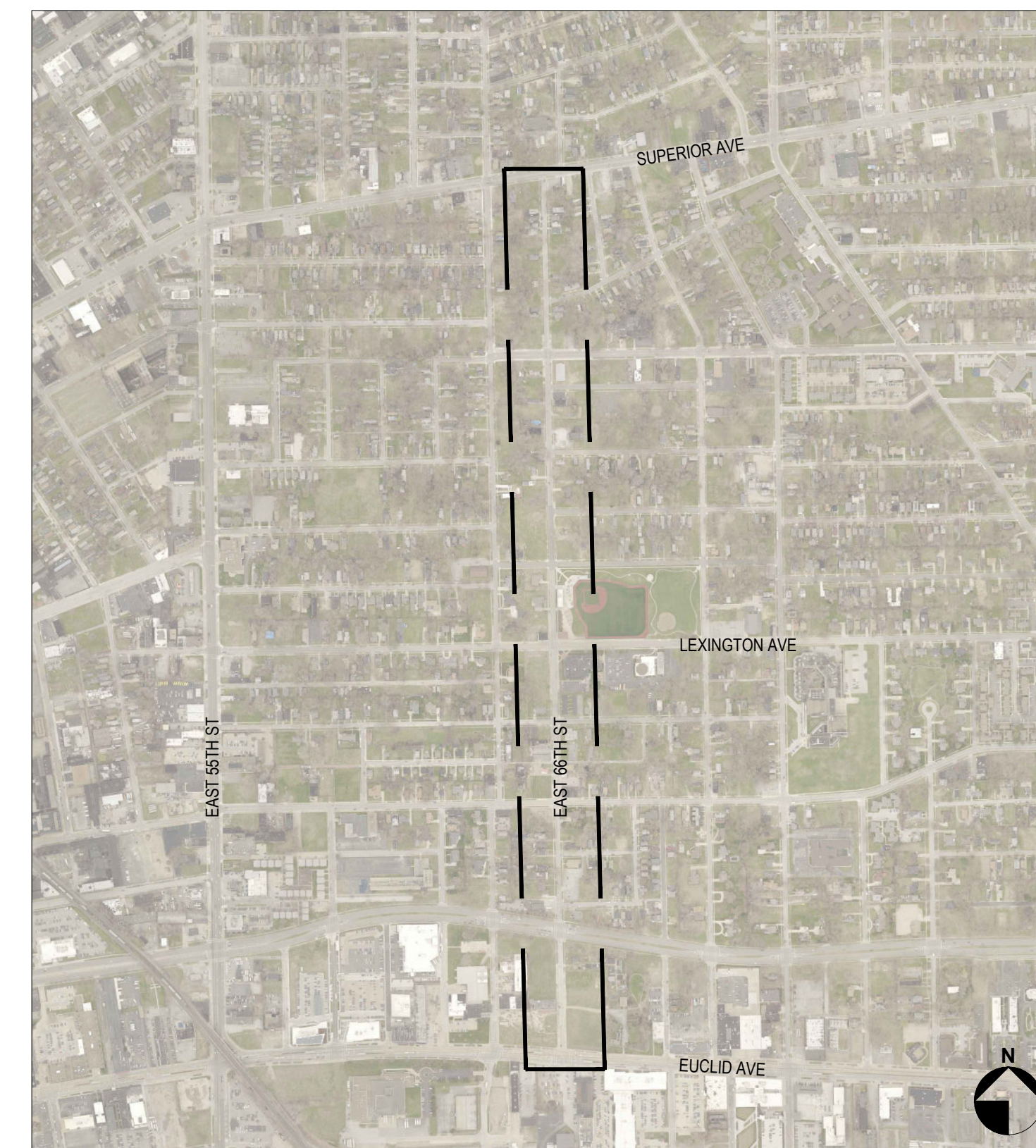

# BASIS OF DESIGN PROJECT COMPONENT SUMMARY

Hardscape, Landscape, and Site Furniture

Category	Component	Preferred Option	Model Number	Color / Finish	Abb.	Unit	Sheet No.	
Hardscape	Standard Concrete			Plain Gray	P1			
	Stamped Concrete or Concrete Pavers				P2			
	Stamped Concrete 1				P4			
	Stamped Concrete 2				P5			
	Accessible Path with Porous Paving Material				P3			
	Painted Continental Crosswalk				CW			
	Landscape	Street Tree 1						
		Street Tree 2						
		Grass 1						
Grass 2								
Shrub 1								
Shrub 2								
Site Furniture	Smart Street Light with Pedestrian Fixture							
	Bollard						<i>* To be determined in next phase</i>	
	Bench						<i>* To be determined in next phase</i>	
	Trash Receptacle						<i>* To be determined in next phase</i>	
	Recycling Receptacle						<i>* To be determined in next phase</i>	

## PROJECT NARRATIVE

THE EAST 66TH STREET STREETScape IS INTENDED TO SERVE AS A NATIONAL MODEL PUBLIC SPACE THAT EMPHASIZES SEAMLESS CONNECTIVITY AND ACCESSIBILITY - PROMOTING PHYSICAL, SOCIAL, AND TECHNOLOGICAL LINKS - WITH AN OVERARCHING COMMITMENT TO JUSTICE AND EQUITY. THE GOAL IS TO CREATE A NEW STANDARD TYPOLOGY FOR NEIGHBORHOOD STREET DESIGN IN THE CITY OF CLEVELAND THAT EMPLOYS ADVANCES IN TECHNOLOGY, CONSTRUCTION MATERIALS AND MAINTENANCE PRACTICES, IMPROVES SAFETY AND ACCESSIBILITY, AND ADDRESSES COMMUNITY HISTORY AND HERITAGE THROUGH A RESIDENT-DRIVEN AND COMMUNITY-RESPONSIVE PROCESS.

THIS PACKAGE IS REFLECTIVE OF A COMMUNITY-FOCUSED CONCEPTUAL DESIGN PROCESS, AND WHILE IT INCORPORATES DETAILS TYPICAL OF A STREETScape DESIGN PACKAGE AT THIS PHASE OF DEVELOPMENT, IT SHOULD BE NOTED THAT THERE ARE ADDITIONAL ELEMENTS THAT MUST BE DESIGNED AND FURTHER REFINED WITH COMMUNITY REPRESENTATIVES AS THE PROJECT MOVES INTO SUBSEQUENT IMPLEMENTATION PHASES. THESE INCLUDE THE FOLLOWING:

- LOCATIONS FOR PUBLIC ART (TO INCLUDE BANNERS, SCULPTURE, OUTDOOR PERFORMANCE SPOTS AND MURALS)
- INDIVIDUAL ART ELEMENTS
- SPECIAL GATEWAY SIGNAGE AND WAYFINDING
- CUSTOM FURNITURE ELEMENTS
- PAVING PATTERNS IN FEATURE AREAS
- DETAILS TO SUPPORT TEMPORARY ROAD CLOSURES FOR SPECIAL EVENTS
- SPECIAL LIGHTING
- TECHNOLOGY ELEMENTS AND ACCESS

## OVERALL SITE PLAN

SCALE: 1:300

1

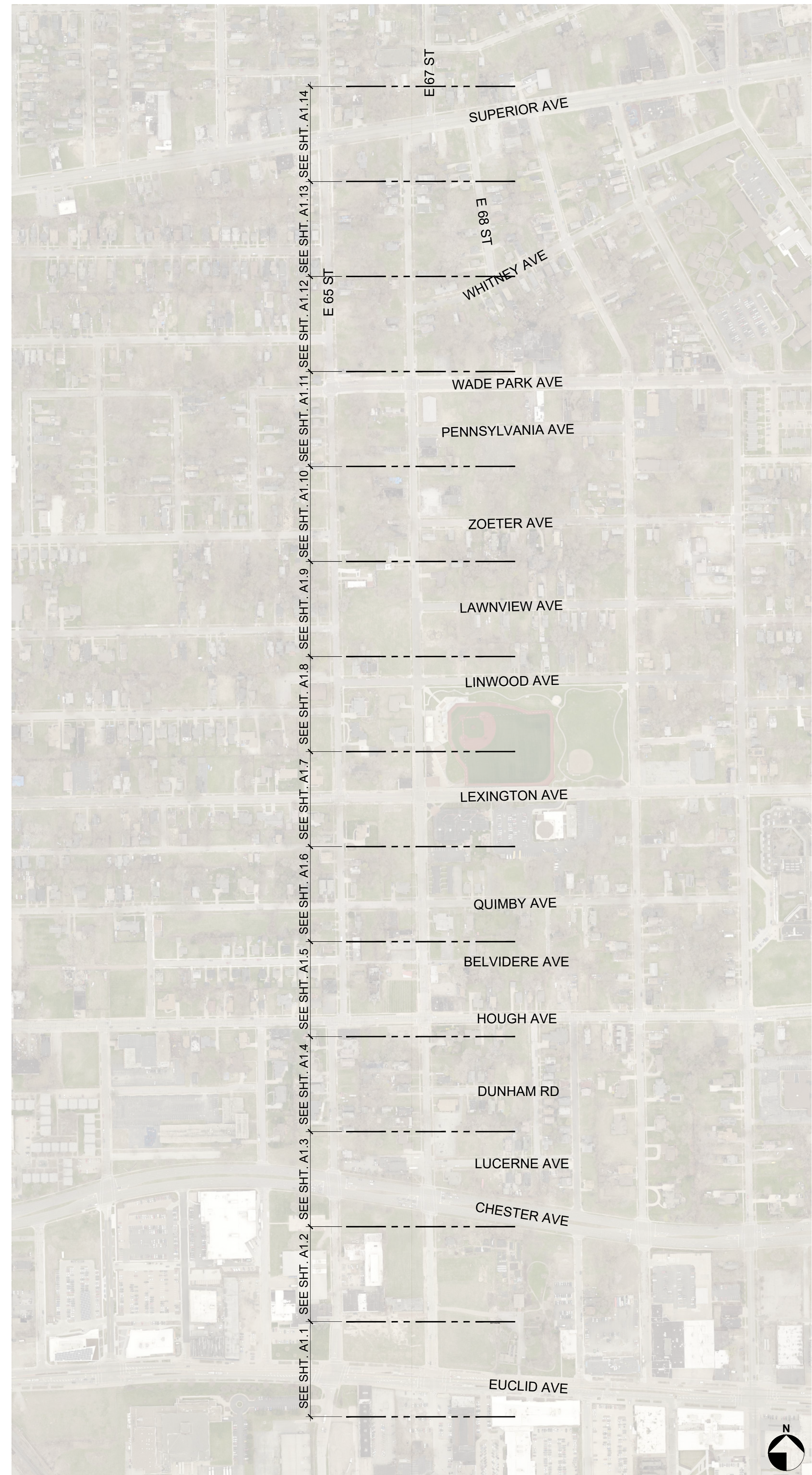

# EAST 66<sup>TH</sup> STREET TLCI

CLEVELAND, OHIO

## OVERALL PLAN & BASIS OF DESIGN SUMMARY

150 0 300 600

### ISSUE:

2020-06-30 - SCHEMATIC DESIGN

### City Architecture

3200 Euclid Avenue  
Cleveland, Ohio 44115  
phone.216.881.2444

www.cityarch.com

Project Number:

20003

Sheet Number:

# A0.1

Copyright © 2020

# EAST 66<sup>TH</sup> STREET TLCI

CLEVELAND, OHIO

## TYPICAL STREET SECTION

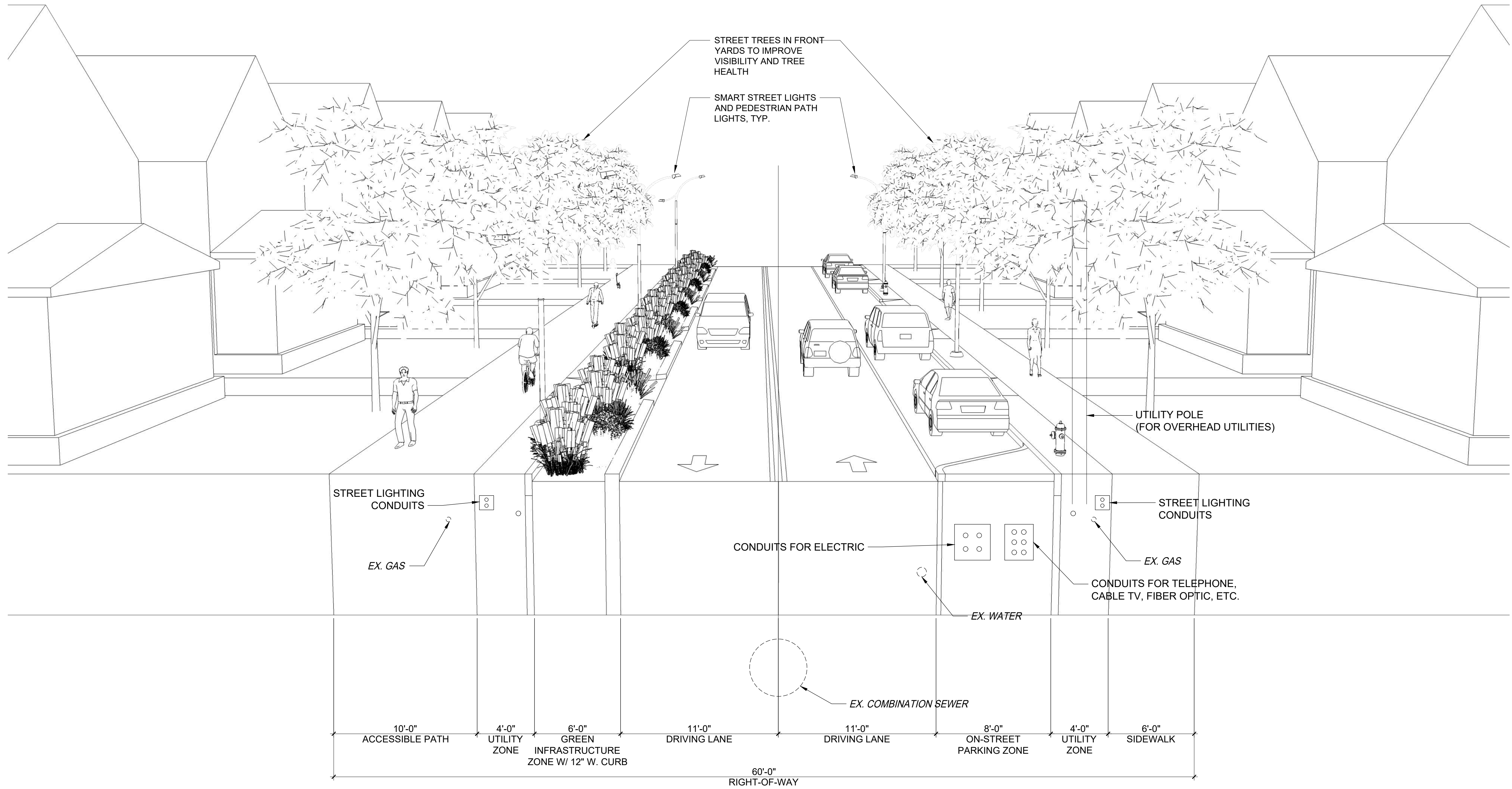

**TYPICAL STREET SECTION**  
SCALE: NTS

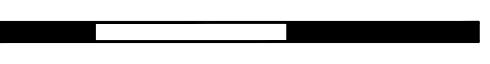

**ISSUE:**  
2020-06-30 - SCHEMATIC DESIGN

**City Architecture**  
3200 Euclid Avenue  
Cleveland, Ohio 44115  
phone.216.881.2444  
www.cityarch.com

Project Number:  
**20003**  
Sheet Number:

**A0.2**

Copyright © 2020

EAST 66<sup>TH</sup>  
STREET  
TLCI

CLEVELAND, OHIO

EAST 66TH AT  
EUCLID AVE

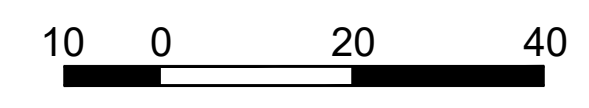
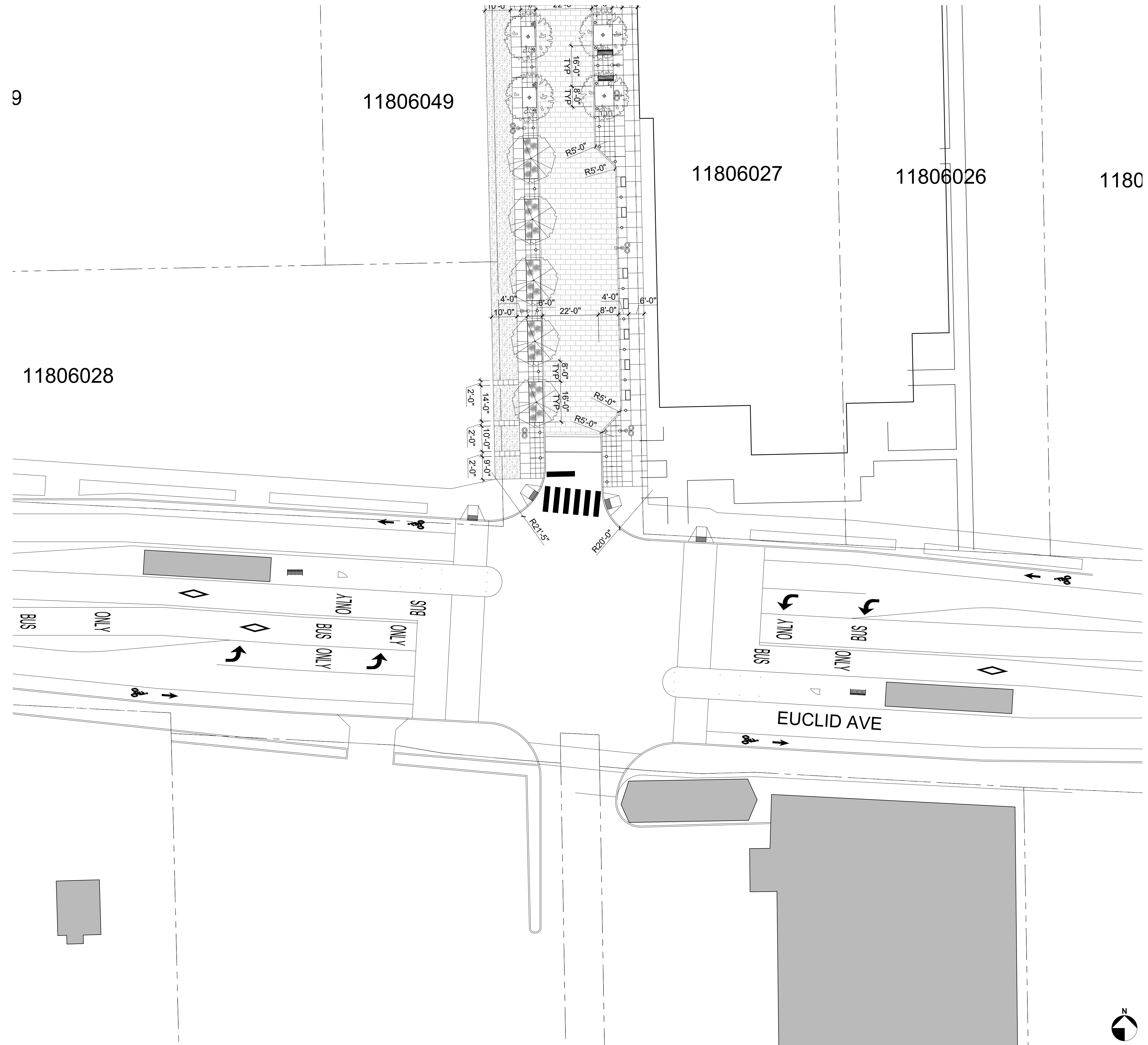

ISSUE:  
2020-06-30 - SCHEMATIC DESIGN

**MATERIAL LEGEND**

	STANDARD CONCRETE (SCORELINES AS DRAWN)
	STAMPED CONCRETE OR CONCRETE PAVERS (COLOR: PATTERN)
	STAMPED CONCRETE (COLOR: PATTERN)
	STAMPED CONCRETE (COLOR: PATTERN)
	ACCESSIBLE PATH W/ POROUS PAVING MATERIAL
	PAINTED CONTINENTAL CROSSWALK
	LANDSCAPING - BIO RETENTION
	LANDSCAPING - GRASS

**AMENITY LEGEND**

	BENCH - 6 FT
	STREETLIGHT
	BOLLARD
	TRASH & RECYCLING RECEPTACLES

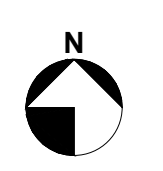

City Architecture  
3200 Euclid Avenue  
Cleveland, Ohio 44115  
phone.216.881.2444  
www.cityarch.com

Project Number:  
**20003**  
Sheet Number:

**A1.1**

Copyright © 2020

EAST 66<sup>TH</sup>  
STREET  
TLCI

CLEVELAND, OHIO

EAST 66TH  
BETWEEN  
EUCLID &  
CHESTER

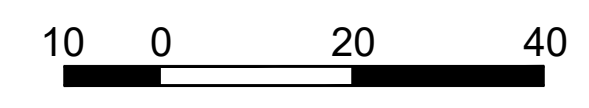
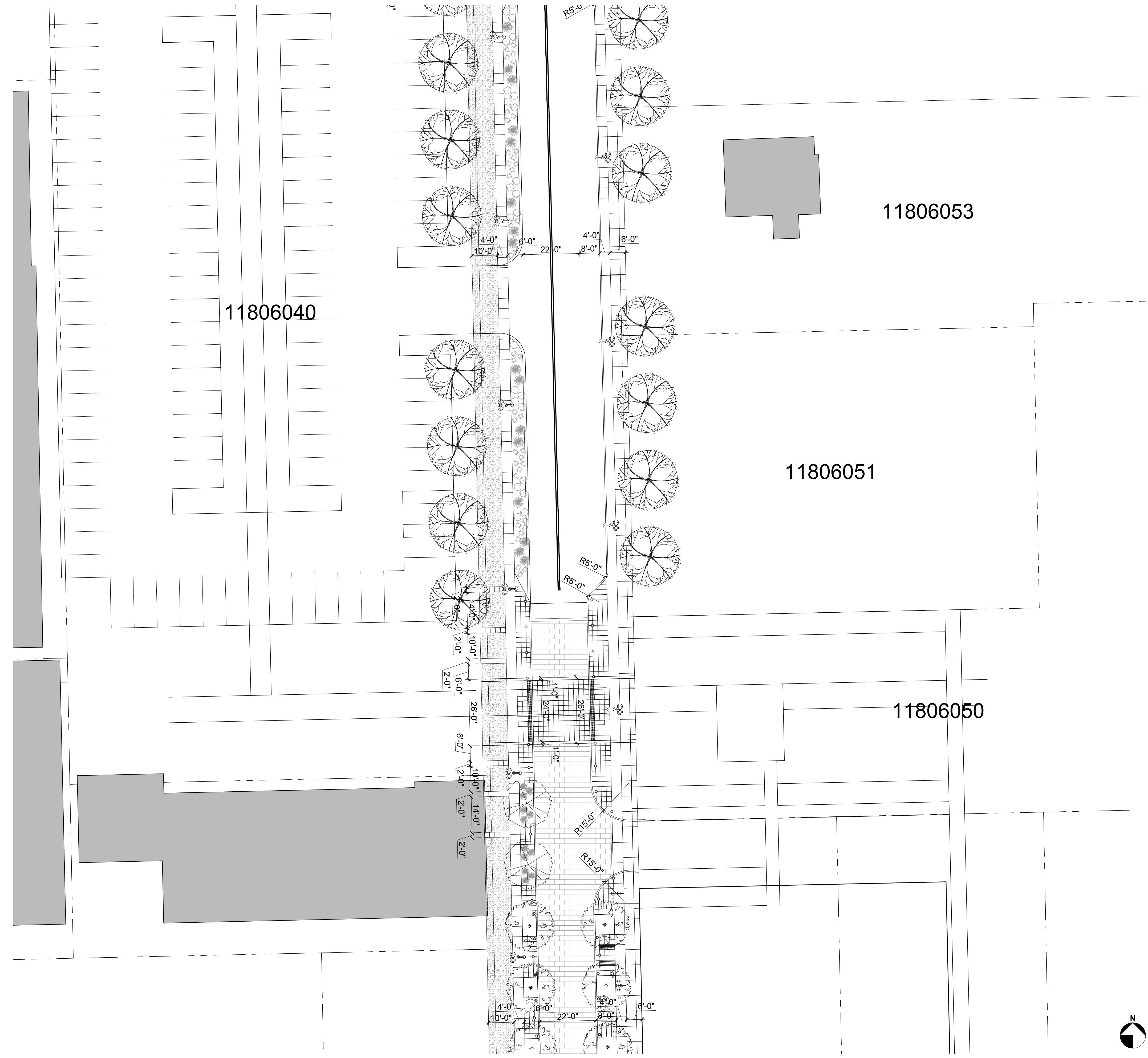

ISSUE:  
2020-06-30 - SCHEMATIC DESIGN

City Architecture  
3200 Euclid Avenue  
Cleveland, Ohio 44115  
phone.216.881.2444  
www.cityarch.com

Project Number:  
20003  
Sheet Number:

A1.2

Copyright © 2020

MATERIAL LEGEND	
	STANDARD CONCRETE (SCORELINES AS DRAWN)
	STAMPED CONCRETE OR CONCRETE PAVERS
	STAMPED CONCRETE (COLOR: PATTERN)
	STAMPED CONCRETE (COLOR: PATTERN)
	ACCESSIBLE PATH W/ POROUS PAVING MATERIAL
	PAINTED CONTINENTAL CROSSWALK
	LANDSCAPING - BIO RETENTION
	LANDSCAPING - GRASS

AMENITY LEGEND	
	BENCH - 6 FT
	STREETLIGHT
	BOLLARD
	TRASH & RECYCLING RECEPTACLES



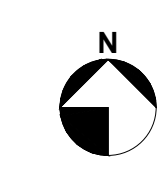

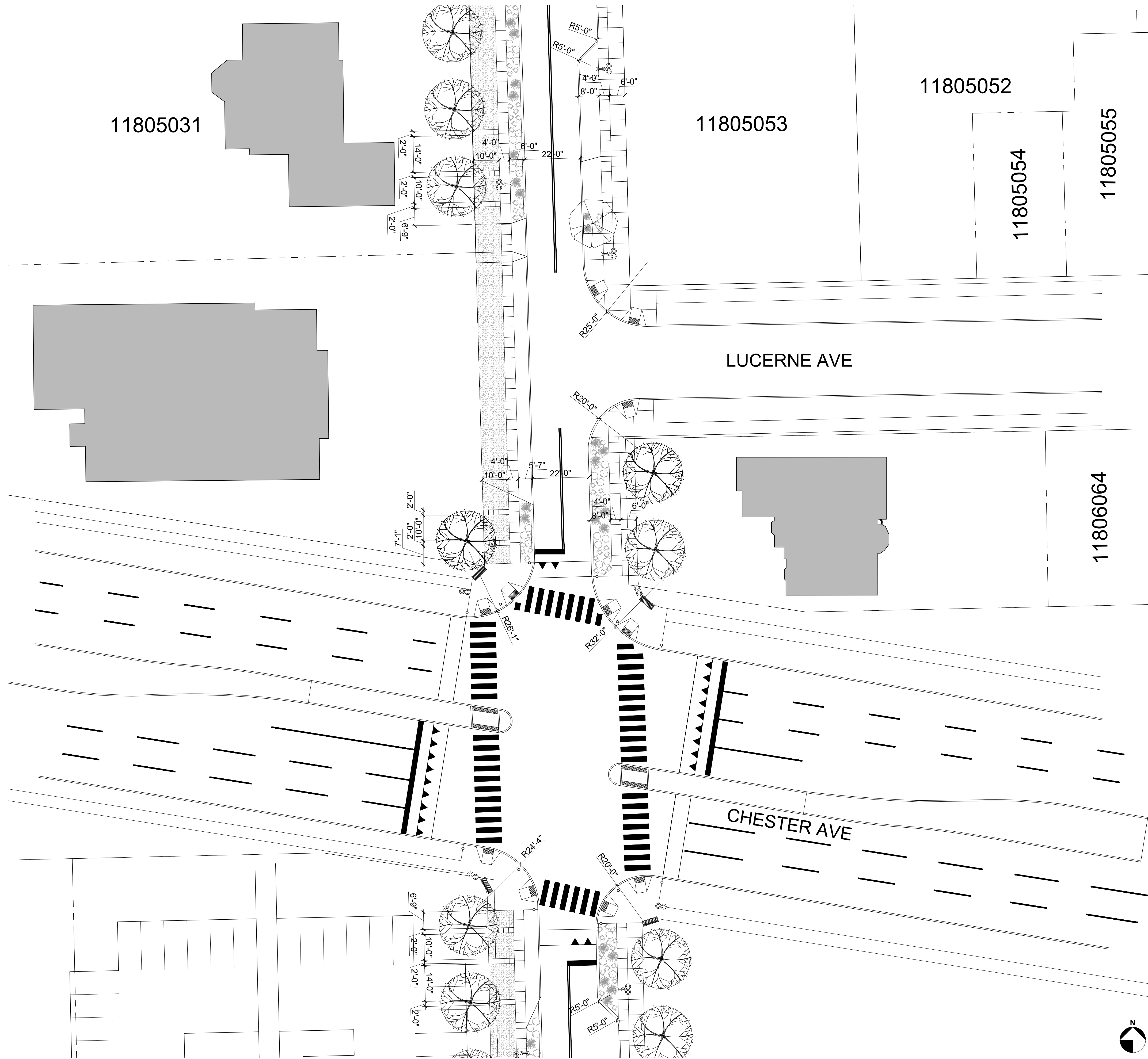
**EAST 66<sup>TH</sup>  
STREET  
TLCI**

CLEVELAND, OHIO

EAST 66TH AT  
CHESTER AVE

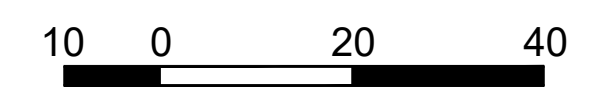

**ISSUE:**  
2020-06-30 - SCHEMATIC DESIGN

**City Architecture**  
3200 Euclid Avenue  
Cleveland, Ohio 44115  
phone.216.881.2444  
www.cityarch.com

Project Number:  
**2003**  
Sheet Number:

**A1.3**

Copyright © 2020

MATERIAL LEGEND	
	STANDARD CONCRETE (SCORELINES AS DRAWN)
	STAMPED CONCRETE OR CONCRETE PAVERS
	STAMPED CONCRETE (COLOR: PATTERN)
	STAMPED CONCRETE (COLOR: PATTERN)
	ACCESSIBLE PATH W/ POROUS PAVING MATERIAL
	PAINTED CONTINENTAL CROSSWALK
	LANDSCAPING - BIO RETENTION
	LANDSCAPING - GRASS

  

AMENITY LEGEND	
	BENCH - 6 FT
	STREETLIGHT
	BOLLARD
	TRASH & RECYCLING RECEPTACLES

# EAST 66<sup>TH</sup> STREET TLCI

CLEVELAND, OHIO

## EAST 66TH AT CHESTER AVE - ENLARGED PLAN

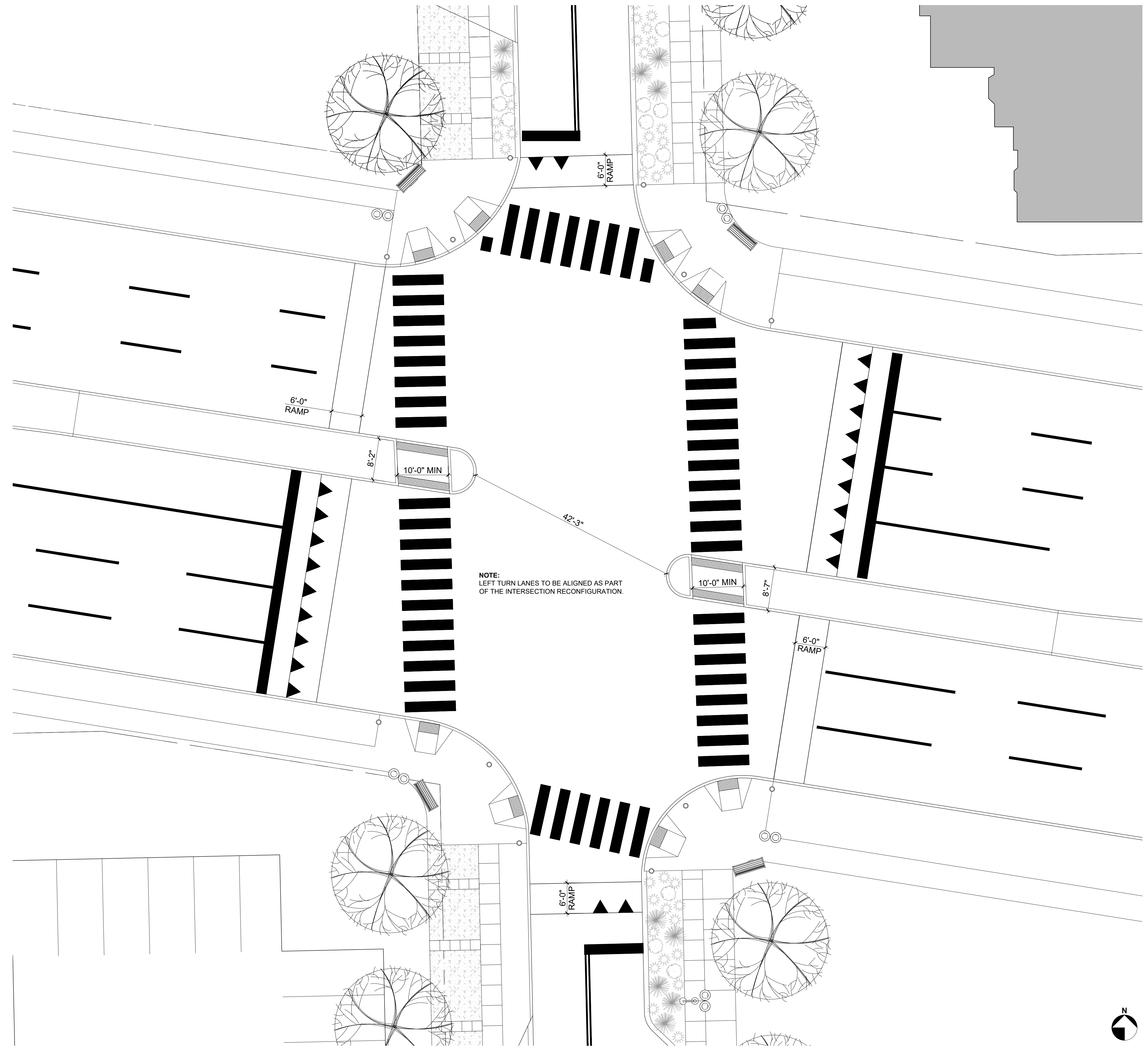

NOTE:  
LEFT TURN LANES TO BE ALIGNED AS PART  
OF THE INTERSECTION RECONFIGURATION.

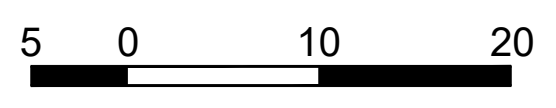

ISSUE:  
2020-06-30 - SCHEMATIC DESIGN

**MATERIAL LEGEND**

	STANDARD CONCRETE (SCORELINES AS DRAWN)
	STAMPED CONCRETE OR CONCRETE PAVERS
	STAMPED CONCRETE (COLOR / PATTERN)
	STAMPED CONCRETE (COLOR / PATTERN)
	ACCESSIBLE PATH W/ POROUS PAVING MATERIAL
	PAINTED CONTINENTAL CROSSWALK
	LANDSCAPING - BIO RETENTION
	LANDSCAPING - GRASS

**AMENITY LEGEND**

	BENCH - 6 FT
	STREETLIGHT
	BOLLARD
	TRASH & RECYCLING RECEPTACLES

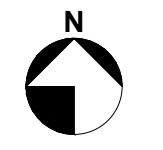

City Architecture  
3200 Euclid Avenue  
Cleveland, Ohio 44115  
phone.216.881.2444  
www.cityarch.com

Project Number:  
**20003**  
Sheet Number:

# A1.3A

Copyright © 2020

**EAST 66<sup>TH</sup>  
STREET  
TLCI**

CLEVELAND, OHIO

EAST 66TH  
BETWEEN  
CHESTER &  
HOUGH

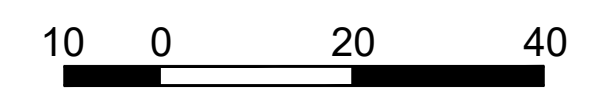

MATERIAL LEGEND	
	STANDARD CONCRETE (SCORELINES AS DRAWN)
	STAMPED CONCRETE OR CONCRETE PAVERS
	STAMPED CONCRETE (COLOR: PATTERN)
	STAMPED CONCRETE (COLOR: PATTERN)
	ACCESSIBLE PATH W/ POROUS PAVING MATERIAL
	PAINTED CONTINENTAL CROSSWALK
	LANDSCAPING - BIO RETENTION
	LANDSCAPING - GRASS

AMENITY LEGEND	
	BENCH - 6 FT
	STREETLIGHT
	BOLLARD
	TRASH & RECYCLING RECEPTACLES

**ISSUE:**  
2020-06-30 - SCHEMATIC DESIGN

**City Architecture**  
3200 Euclid Avenue  
Cleveland, Ohio 44115  
phone.216.881.2444  
www.cityarch.com

Project Number:  
**20003**  
Sheet Number:

**A1.4**

Copyright © 2020



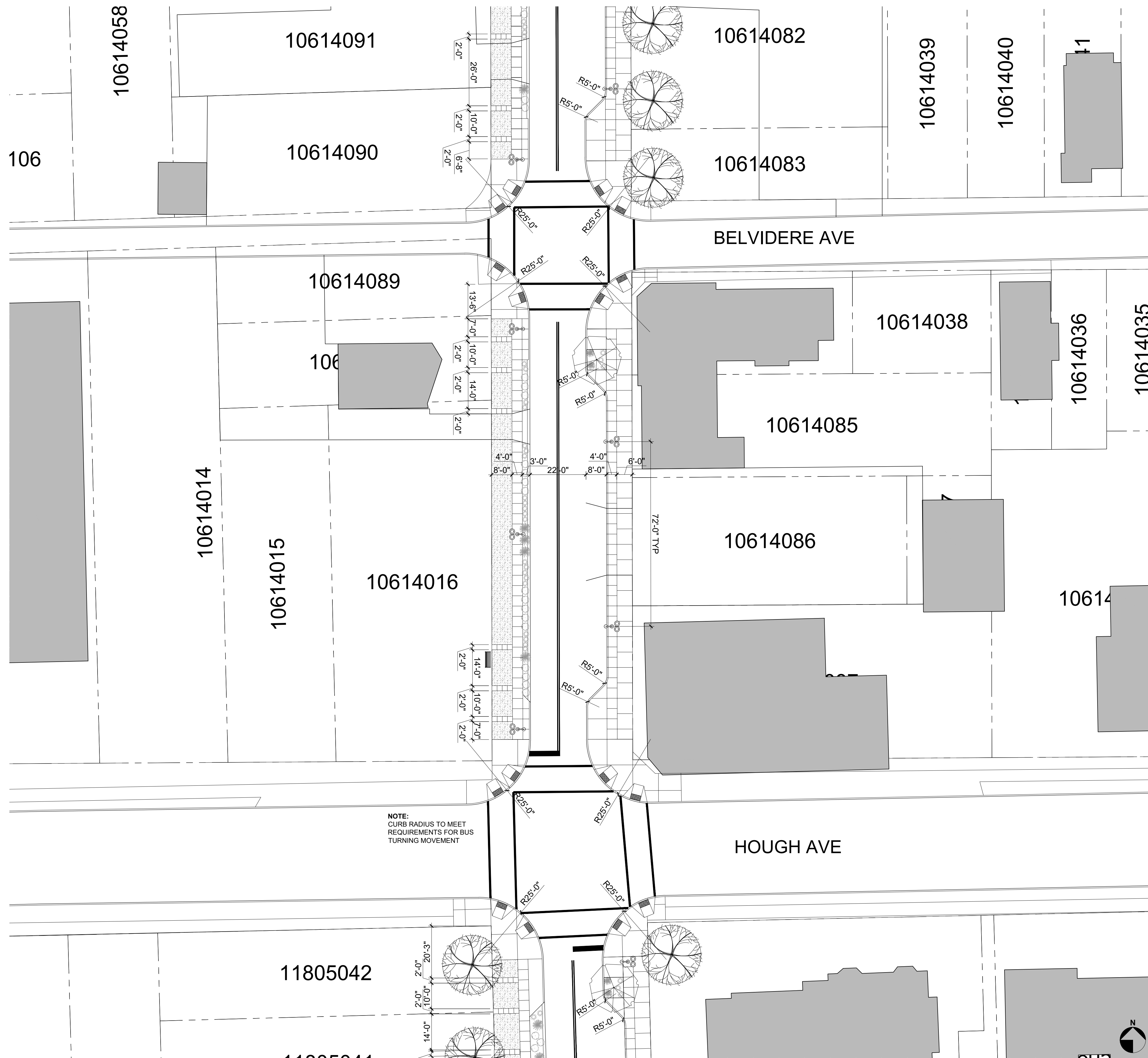

EAST 66<sup>TH</sup>  
STREET  
TLCI

CLEVELAND, OHIO

EAST 66TH AT  
HOUGH AVE

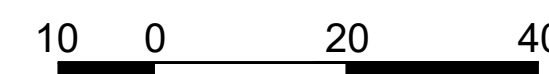

ISSUE:  
2020-06-30 - SCHEMATIC DESIGN

City Architecture

3200 Euclid Avenue  
Cleveland, Ohio 44115  
phone.216.881.2444

www.cityarch.com

Project Number:

20003

Sheet Number:

A1.5

Copyright © 2020

MATERIAL LEGEND	
	STANDARD CONCRETE (SCORELINES AS DRAWN)
	STAMPED CONCRETE OR CONCRETE PAVERS
	STAMPED CONCRETE (COLOR: PATTERN)
	STAMPED CONCRETE (COLOR: PATTERN)
	ACCESSIBLE PATH W/ POROUS PAVING MATERIAL
	PAINTED CONTINENTAL CROSSWALK
	LANDSCAPING - BIO RETENTION
	LANDSCAPING - GRASS

  

AMENITY LEGEND	
	BENCH - 6 FT
	STREETLIGHT
	BOLLARD
	TRASH & RECYCLING RECEPTACLES

**EAST 66<sup>TH</sup>  
STREET  
TLCI**

CLEVELAND, OHIO

EAST 66TH  
BETWEEN  
HOUGH &  
LEXINGTON

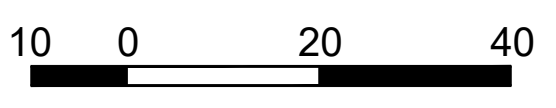

**ISSUE:**  
2020-06-30 - SCHEMATIC DESIGN

**City Architecture**  
3200 Euclid Avenue  
Cleveland, Ohio 44115  
phone.216.881.2444  
www.cityarch.com

Project Number:  
**2003**  
Sheet Number:

**A1.6**

Copyright © 2020

MATERIAL LEGEND	
	STANDARD CONCRETE (SCORELINES AS DRAWN)
	STAMPED CONCRETE OR CONCRETE PAVERS
	STAMPED CONCRETE (COLOR: PATTERN)
	STAMPED CONCRETE (COLOR: PATTERN)
	ACCESSIBLE PATH W/ POROUS PAVING MATERIAL
	PAINTED CONTINENTAL CROSSWALK
	LANDSCAPING - BIO RETENTION
	LANDSCAPING - GRASS

AMENITY LEGEND	
	BENCH - 6 FT
	STREETLIGHT
	BOLLARD
	TRASH & RECYCLING RECEPTACLES

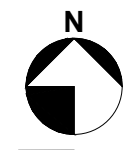

EAST 66<sup>TH</sup>  
STREET  
TLCI

CLEVELAND, OHIO

EAST 66TH AT  
LEXINGTON AVE

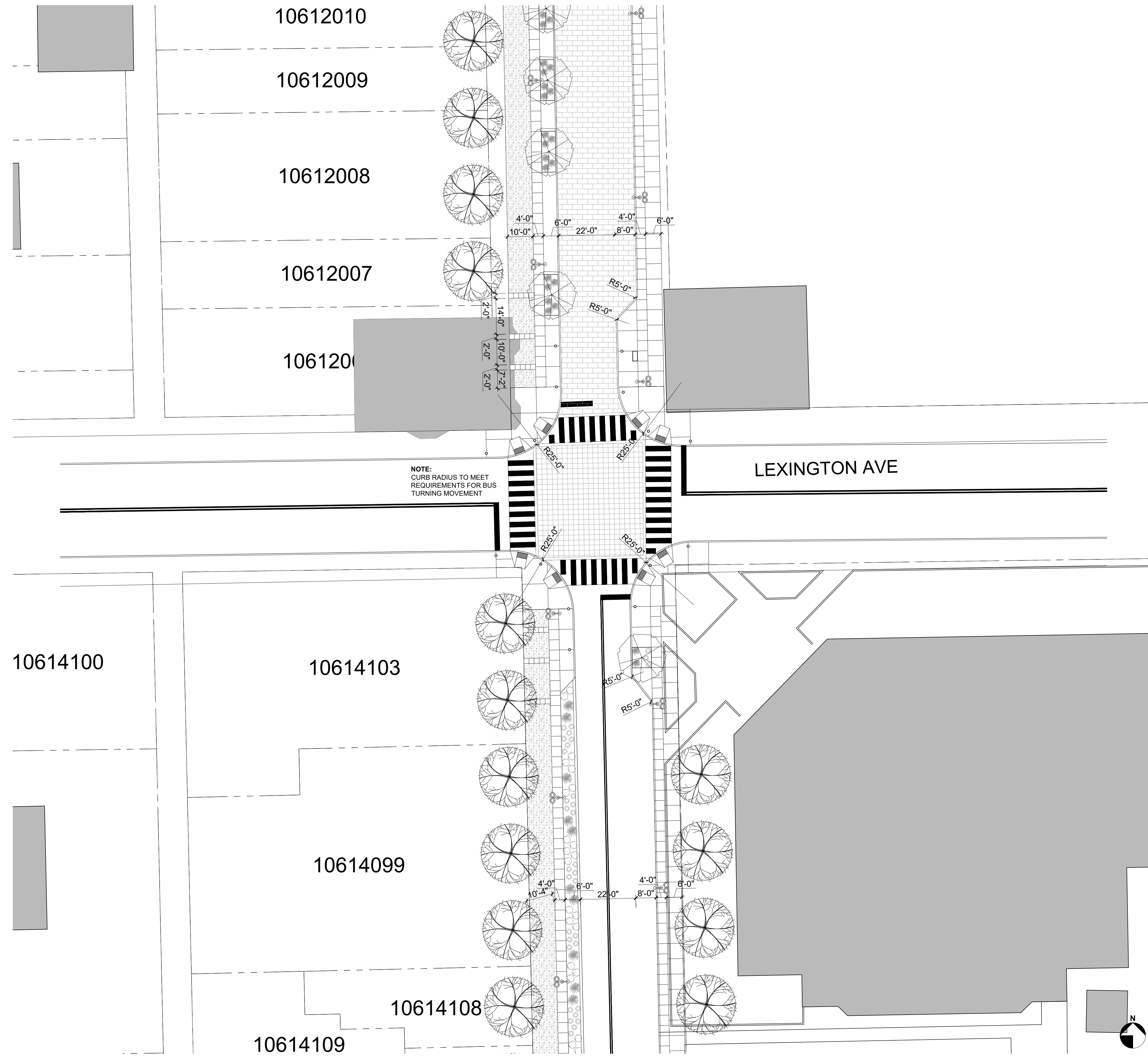

NOTE:  
CURB RADIUS TO MEET  
REQUIREMENTS FOR BUS  
TURNING MOVEMENT

LEXINGTON AVE

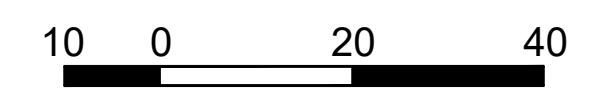

ISSUE:  
2020-06-30 - SCHEMATIC DESIGN

MATERIAL LEGEND	
	STANDARD CONCRETE (SCORELINES AS DRAWN)
	STAMPED CONCRETE OR CONCRETE PAVERS (COLOR: PATTERN)
	STAMPED CONCRETE (COLOR: PATTERN)
	STAMPED CONCRETE (COLOR: PATTERN)
	ACCESSIBLE PATH W/ POROUS PAVING MATERIAL
	PAINTED CONTINENTAL CROSSWALK
	LANDSCAPING - BIO RETENTION
	LANDSCAPING - GRASS

AMENITY LEGEND	
	BENCH - 6 FT
	STREETLIGHT
	BOLLARD
	TRASH & RECYCLING RECEPTACLES

City Architecture  
3200 Euclid Avenue  
Cleveland, Ohio 44115  
phone.216.881.2444  
www.cityarch.com

Project Number:  
20003  
Sheet Number:

A1.7

Copyright © 2020

312007

31200

10614103

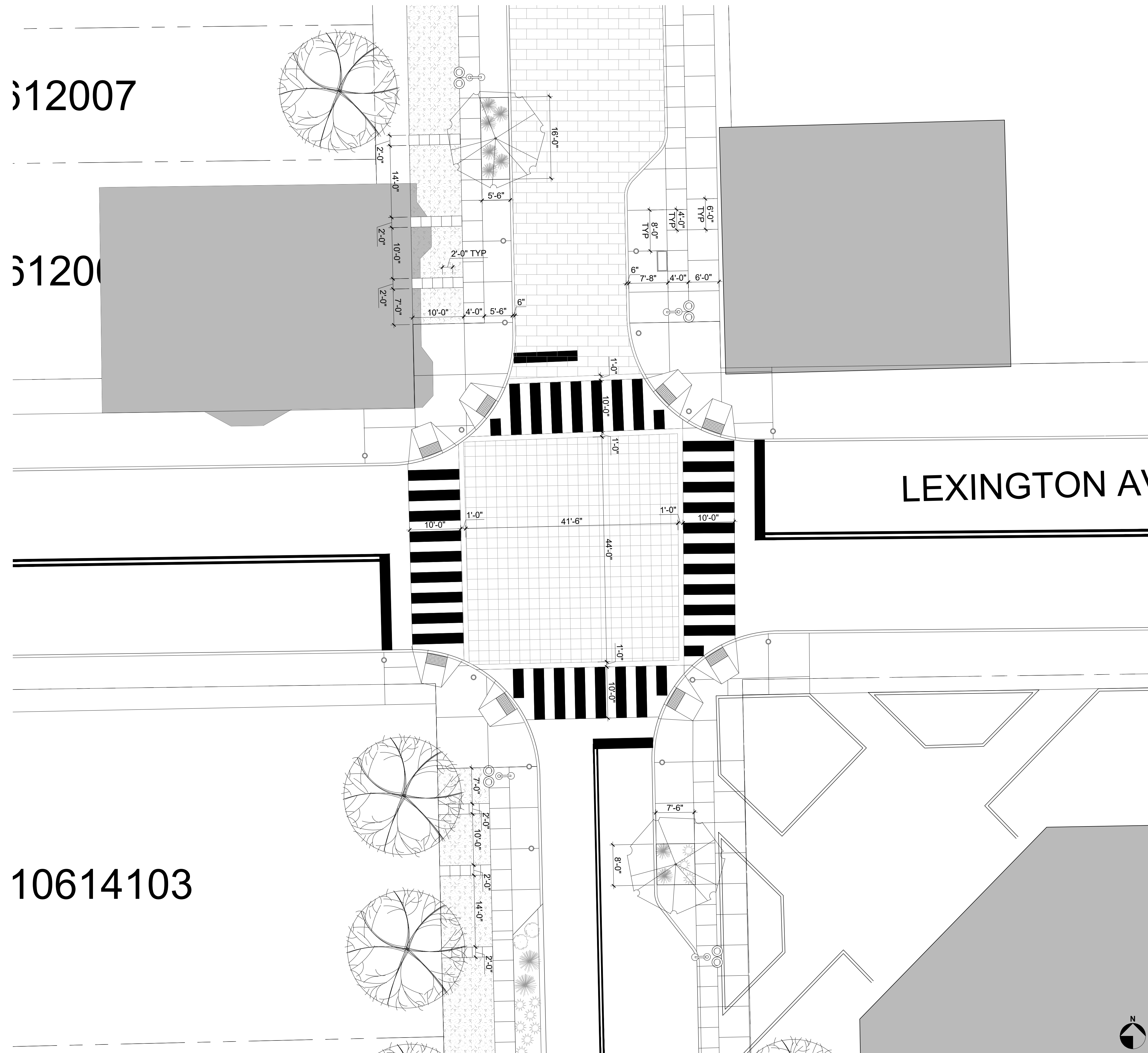

EAST 66<sup>TH</sup>  
STREET  
TLCI

CLEVELAND, OHIO

EAST 66TH AT  
LEXINGTON AVE  
- ENLARGED  
PLAN

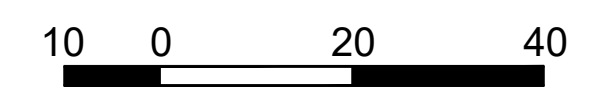

ISSUE:  
2020-06-30 - SCHEMATIC DESIGN

City Architecture  
3200 Euclid Avenue  
Cleveland, Ohio 44115  
phone.216.881.2444  
www.cityarch.com

Project Number:  
20003  
Sheet Number:

A1.7A

Copyright © 2020

MATERIAL LEGEND	
	STANDARD CONCRETE (SCORELINES AS DRAWN)
	STAMPED CONCRETE OR CONCRETE PAVERS
	STAMPED CONCRETE (COLOR: PATTERN)
	STAMPED CONCRETE (COLOR: PATTERN)
	ACCESSIBLE PATH W/ POROUS PAVING MATERIAL
	PAINTED CONTINENTAL CROSSWALK
	LANDSCAPING - BIO RETENTION
	LANDSCAPING - GRASS

AMENITY LEGEND	
	BENCH - 6 FT
	STREETLIGHT
	BOLLARD
	TRASH & RECYCLING RECEPTACLES

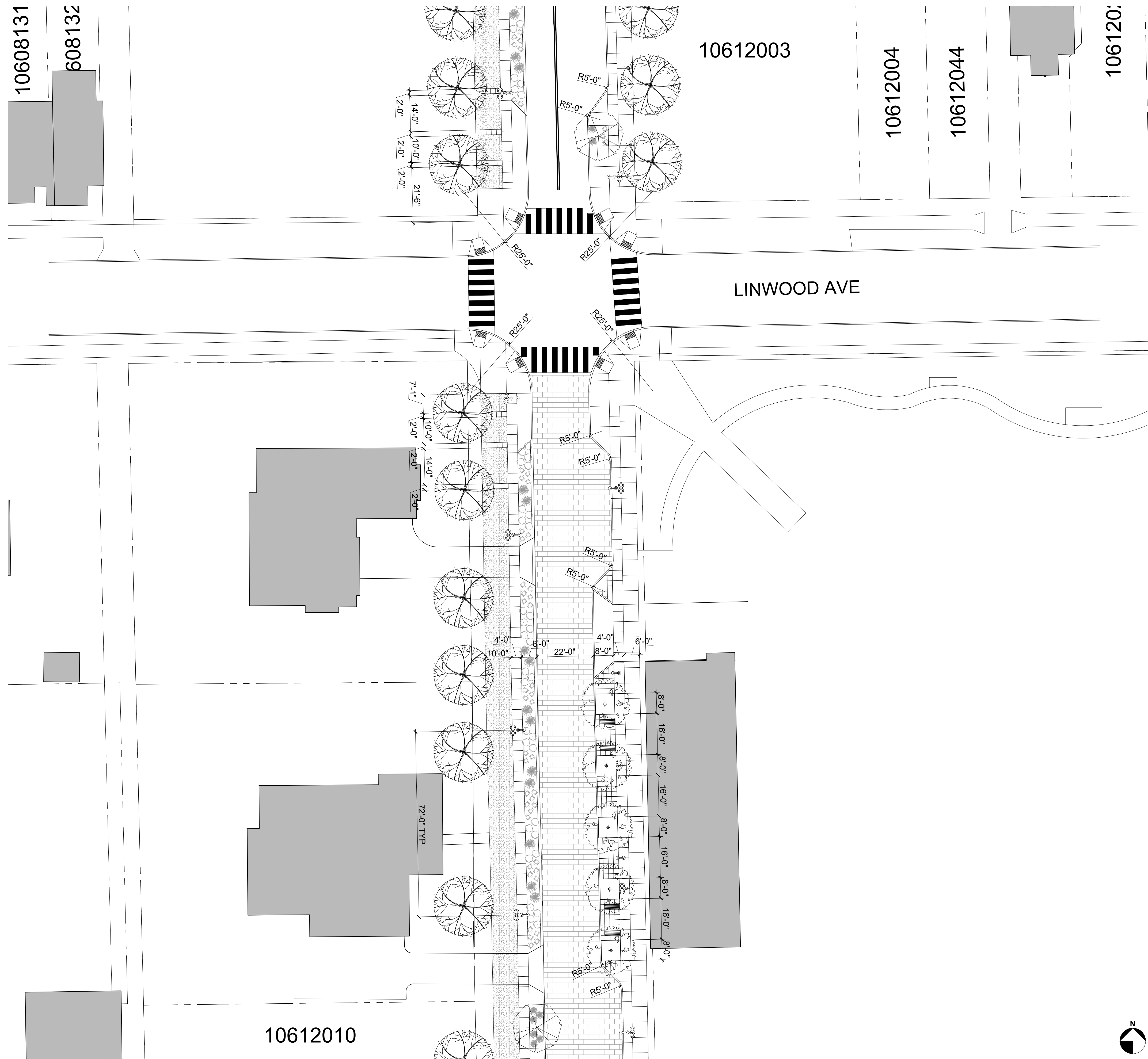

EAST 66<sup>TH</sup>  
STREET  
TLCI

CLEVELAND, OHIO

EAST 66TH  
NORTH OF  
LEXINGTON AVE

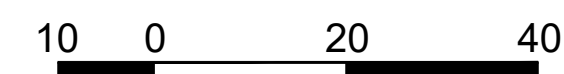

ISSUE:  
2020-06-30 - SCHEMATIC DESIGN

City Architecture

3200 Euclid Avenue  
Cleveland, Ohio 44115  
phone.216.881.2444

www.cityarch.com

Project Number:

2003

Sheet Number:

A1.8

Copyright © 2020

MATERIAL LEGEND	
	STANDARD CONCRETE (SCORELINES AS DRAWN)
	STAMPED CONCRETE OR CONCRETE PAVERS
	STAMPED CONCRETE (COLOR: PATTERN)
	STAMPED CONCRETE (COLOR: PATTERN)
	ACCESSIBLE PATH W/ POROUS PAVING MATERIAL
	PAINTED CONTINENTAL CROSSWALK
	LANDSCAPING - BIO RETENTION
	LANDSCAPING - GRASS

AMENITY LEGEND	
	BENCH - 6 FT
	STREETLIGHT
	BOLLARD
	TRASH & RECYCLING RECEPTACLES



**EAST 66<sup>TH</sup>  
STREET  
TLCI**

CLEVELAND, OHIO

EAST 66TH  
BETWEEN  
LEXINGTON &  
WADE PARK

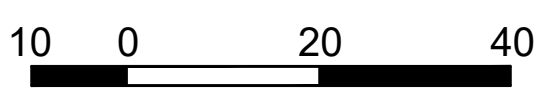

**ISSUE:**  
2020-06-30 - SCHEMATIC DESIGN

**City Architecture**  
3200 Euclid Avenue  
Cleveland, Ohio 44115  
phone.216.881.2444  
www.cityarch.com

Project Number:  
**20003**  
Sheet Number:

**A1.9**

Copyright © 2020

MATERIAL LEGEND	
	STANDARD CONCRETE (SCORELINES AS DRAWN)
	STAMPED CONCRETE OR CONCRETE PAVERS (COLOR: PATTERN)
	STAMPED CONCRETE (COLOR: PATTERN)
	STAMPED CONCRETE (COLOR: PATTERN)
	ACCESSIBLE PATH W/ POROUS PAVING MATERIAL
	PAINTED CONTINENTAL CROSSWALK
	LANDSCAPING - BIO RETENTION
	LANDSCAPING - GRASS

AMENITY LEGEND	
	BENCH - 6 FT
	STREETLIGHT
	BOLLARD
	TRASH & RECYCLING RECEPTACLES

3131  
3132

EAST 66<sup>TH</sup>  
STREET  
TLCI

CLEVELAND, OHIO

EAST 66TH  
SOUTH OF  
WADE PARK

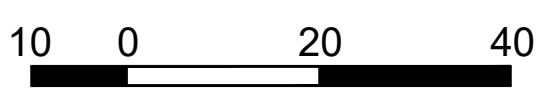

ISSUE:  
2020-06-30 - SCHEMATIC DESIGN

City Architecture  
3200 Euclid Avenue  
Cleveland, Ohio 44115  
phone.216.881.2444  
www.cityarch.com

Project Number:  
20003  
Sheet Number:

A1.10

Copyright © 2020

MATERIAL LEGEND	
	STANDARD CONCRETE (SCORELINES AS DRAWN)
	STAMPED CONCRETE OR CONCRETE PAVERS (COLOR: PATTERN)
	STAMPED CONCRETE (COLOR: PATTERN)
	STAMPED CONCRETE (COLOR: PATTERN)
	ACCESSIBLE PATH W/ POROUS PAVING MATERIAL
	PAINTED CONTINENTAL CROSSWALK
	LANDSCAPING - BIO RETENTION
	LANDSCAPING - GRASS

AMENITY LEGEND	
	BENCH - 6 FT
	STREETLIGHT
	BOLLARD
	TRASH & RECYCLING RECEPTACLES



**EAST 66<sup>TH</sup> STREET**  
**TLCI**

CLEVELAND, OHIO

**EAST 66<sup>TH</sup> AT**  
**WADE PARK AVE**

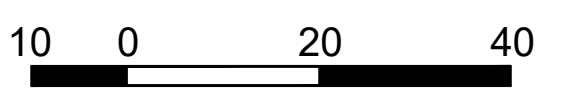

**ISSUE:**  
 2020-06-30 - SCHEMATIC DESIGN

**City Architecture**  
 3200 Euclid Avenue  
 Cleveland, Ohio 44115  
 phone.216.881.2444  
 www.cityarch.com

Project Number:  
**2003**  
 Sheet Number:

**A1.11**

Copyright © 2020

MATERIAL LEGEND	
[Symbol]	STANDARD CONCRETE (SCORELINES AS DRAWN)
[Symbol]	STAMPED CONCRETE OR CONCRETE PAVERS (COLOR: PATTERN)
[Symbol]	STAMPED CONCRETE (COLOR: PATTERN)
[Symbol]	STAMPED CONCRETE (COLOR: PATTERN)
[Symbol]	ACCESSIBLE PATH W/ POROUS PAVING MATERIAL
[Symbol]	PAINTED CONTINENTAL CROSSWALK
[Symbol]	LANDSCAPING - BIO RETENTION
[Symbol]	LANDSCAPING - GRASS

AMENITY LEGEND	
[Symbol]	BENCH - 6 FT
[Symbol]	STREETLIGHT
[Symbol]	BOLLARD
[Symbol]	TRASH & RECYCLING RECEPTACLES



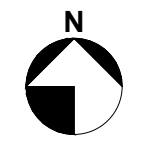

**EAST 66<sup>TH</sup>  
STREET  
TLCI**

CLEVELAND, OHIO

EAST 66TH  
NORTH OF  
WADE PARK AVE

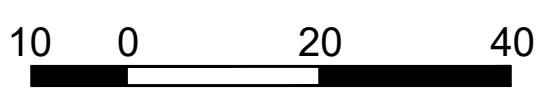

**ISSUE:**  
2020-06-30 - SCHEMATIC DESIGN

**City Architecture**  
3200 Euclid Avenue  
Cleveland, Ohio 44115  
phone.216.881.2444  
www.cityarch.com

Project Number:  
**20003**  
Sheet Number:

**A1.12**

Copyright © 2020

MATERIAL LEGEND	
	STANDARD CONCRETE (SCORELINES AS DRAWN)
	STAMPED CONCRETE OR CONCRETE PAVERS
	STAMPED CONCRETE (COLOR: PATTERN)
	STAMPED CONCRETE (COLOR: PATTERN)
	ACCESSIBLE PATH W/ POROUS PAVING MATERIAL
	PAINTED CONTINENTAL CROSSWALK
	LANDSCAPING - BIO RETENTION
	LANDSCAPING - GRASS

  

AMENITY LEGEND	
	BENCH - 6 FT
	STREETLIGHT
	BOLLARD
	TRASH & RECYCLING RECEPTACLES

**EAST 66<sup>TH</sup>  
STREET  
TLCI**

CLEVELAND, OHIO

EAST 66TH  
SOUTH OF  
SUPERIOR AVE

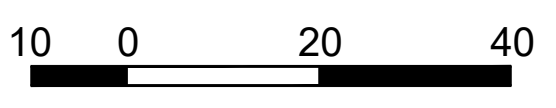

**ISSUE:**  
2020-06-30 - SCHEMATIC DESIGN

**City Architecture**  
3200 Euclid Avenue  
Cleveland, Ohio 44115  
phone.216.881.2444  
www.cityarch.com

Project Number:  
**20003**  
Sheet Number:

**A1.13**  
Copyright © 2020

MATERIAL LEGEND	
	STANDARD CONCRETE (SCORELINES AS DRAWN)
	STAMPED CONCRETE OR CONCRETE PAVERS (COLOR: PATTERN)
	STAMPED CONCRETE (COLOR: PATTERN)
	STAMPED CONCRETE (COLOR: PATTERN)
	ACCESSIBLE PATH W/ POROUS PAVING MATERIAL
	PAINTED CONTINENTAL CROSSWALK
	LANDSCAPING - BIO RETENTION
	LANDSCAPING - GRASS

AMENITY LEGEND	
	BENCH - 6 FT
	STREETLIGHT
	BOLLARD
	TRASH & RECYCLING RECEPTACLES

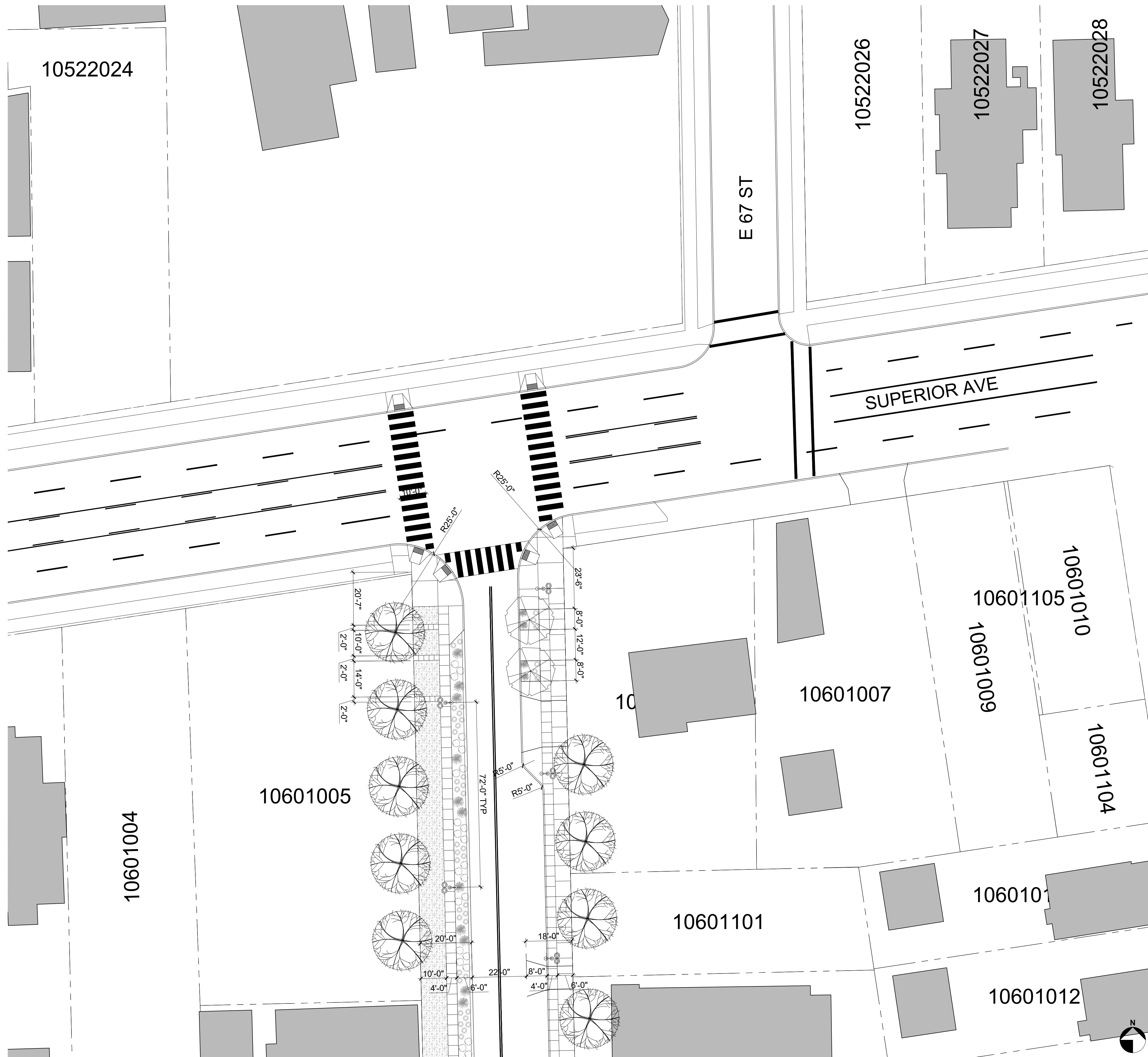

**EAST 66<sup>TH</sup>  
STREET  
TLCI**

CLEVELAND, OHIO

EAST 66TH AT  
SUPERIOR AVE

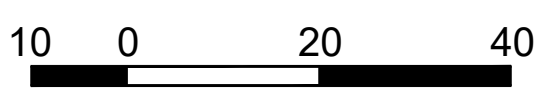

**ISSUE:**  
2020-06-30 - SCHEMATIC DESIGN

**City Architecture**  
3200 Euclid Avenue  
Cleveland, Ohio 44115  
phone.216.881.2444  
www.cityarch.com

Project Number:  
**2003**  
Sheet Number:

**A1.14**

Copyright © 2020

MATERIAL LEGEND	
	STANDARD CONCRETE (SCORELINES AS DRAWN)
	STAMPED CONCRETE OR CONCRETE PAVERS (COLOR: PATTERN)
	STAMPED CONCRETE (COLOR: PATTERN)
	STAMPED CONCRETE (COLOR: PATTERN)
	ACCESSIBLE PATH W/ POROUS PAVING MATERIAL
	PAINTED CONTINENTAL CROSSWALK
	LANDSCAPING - BIO RETENTION
	LANDSCAPING - GRASS

AMENITY LEGEND	
	BENCH - 6 FT
	STREETLIGHT
	BOLLARD
	TRASH & RECYCLING RECEPTACLES